

# 2012 Kentucky Fruit and Vegetable Conference and Trade Show

JANUARY 5-6, 2012

Thursday and Friday

Kentucky State Horticulture Society  
156th Annual Meeting

-----

Kentucky Vegetable Growers Association  
41th Annual Meeting

-----

Kentucky Farmers' Market Association  
6th Annual Meeting

-----

Organic Association of Kentucky  
3rd Annual Meeting

-----

Kentucky Vineyard Society  
Annual Meeting

-----

Kentucky Wine Association

*In cooperation with:  
University of Kentucky  
College of Agriculture  
Kentucky State University  
and  
Kentucky Department of Agriculture*

Meeting Place:  
Embassy Suites Hotel  
1801 Newtown Pike  
Lexington, Kentucky 40511  
(859) 455-5000  
FAX (859) 455-5122  
Reservations: 800-EMBASSY

# Meeting Outline

## Wednesday, January 4 Pre-conference Sessions

## Room

|                |                                |                  |
|----------------|--------------------------------|------------------|
| 3:00-5:30 p.m. | Winemaking Techniques Workshop | Coldstream 1 & 2 |
| 7:30-9:30 p.m. | Fruit Round Table Discussion   | Coldstream 4     |
| 5:00-9:00 p.m. | Exhibitor Set-up               |                  |

## Thursday, January 5

|                |  |                  |
|----------------|--|------------------|
| 8:00 a.m.      | Exhibits Open                          |                  |
| 8:50 a.m.      | Concurrent Sessions                    |                  |
|                | KSHS-KVGA Joint Session                | Coldstream 3     |
|                | Winemaking                             | Coldstream 1 & 2 |
| 10:30 a.m.     | Break                                  |                  |
| Noon           | Exhibitors & Growers Luncheon          | Coldstream 1 & 2 |
| 1:30 p.m.      | Concurrent Sessions                    |                  |
|                | Farmers' Markets                       | Coldstream 1 & 2 |
|                | Agritourism and Social Media           | Coldstream 3     |
|                | Vegetable Production                   | Coldstream 4     |
|                | Tree Fruit And Blueberry Production    | Coldstream 5     |
| 2:30 p.m.      | Break                                  |                  |
| 5:15 p.m.      | Exhibits Close                         |                  |
| 5:30 p.m.      | Celebration of Kentucky Wines          | Coldstream 1 & 2 |
| 6:30-9:00 p.m. | Reception and Kentucky Farmers' Market |                  |
|                | Association Annual Meeting             | Coldstream 3     |

## Friday, January 6

|            |                               |                  |
|------------|-------------------------------|------------------|
| 8:00 a.m.  | Exhibits Open                 |                  |
| 8:30 a.m.  | Concurrent Sessions           |                  |
|            | Organic Farming and Gardening | Coldstream 1 & 2 |
|            | Vegetable Production          | Coldstream 3     |
|            | Grape & Wine Short Course     | Coldstream 4     |
|            | Tree Fruit                    | Coldstream 5     |
|            | Blueberry Production          | Fayette          |
| 10:00 a.m. | Break                         |                  |
| Noon       | Grower Awards Luncheon        | Coldstream 1 & 2 |
| 1:30 p.m.  | Concurrent Sessions           |                  |
|            | Small Fruit Production        | Coldstream 1 & 2 |
|            | Marketing                     | Coldstream 3     |
|            | Grape & Wine Short Course     | Coldstream 4     |
|            | Hydroponic Tomato Production  | Coldstream 5     |
|            | Wholesale Marketing           | Fayette          |
| 2:30 p.m.  | Break                         |                  |
| 3:00 p.m.  | Exhibit Hall Closes           |                  |

Dear Fruit and Vegetable Growers:

The 2012 Kentucky Fruit and Vegetable Conference and Trade Show will again be at the Embassy Suites Hotel, Lexington, KY, Thursday and Friday, January 5 and 6, 2012. Highlights of this year's meeting will be a pre-conference Winemaking Techniques Workshop and a Fruit Round Table Discussion. During the conference there will be sessions on Farmers' Markets, Commercial Fruit and Vegetable Production, Hydroponic Tomato Production, Small Fruit Production, Organic Farming and Gardening, the Grape and Wine Short Course, Winemaking, Agritourism and Social Media, Marketing, Wholesale Marketing, and Blueberry Production. We have many excellent out-of-state speakers this year including Dr. Mike Ellis, Extension Plant Pathologist; Dr. Diane Miller, Associate Professor, and Kyle Daniel, Ph.D. student from Ohio State University; Jeff Kindhart, Senior Research Specialist, Dixon Springs Agricultural Center, Simpson, IL; Dr. Rick Snyder, Extension Specialist for Greenhouse and Field Vegetable Crops, Mississippi State University, Crystal Springs, MS; Richard Barnes, Trellis Growing Systems, Fort Wayne, IN, and Dr. David Lockwood, and Dr. Annette Wszelaki, Extension Fruit and Vegetable Specialists respectively, from the University of Tennessee, Knoxville, TN.

The KVS will have an optional Celebration of Kentucky Wines featuring Kentucky wines. This year we have decided not to have a banquet and will have a Grower Awards Luncheon instead on January 6th.

We will have a Trading Post bulletin board to sell used equipment. If you are looking for equipment buyers, bring along a description containing your name, phone number and the equipment price.

PLEASE make your room reservations directly with the hotel. **Our block of rooms will be held until Jan. 2, 2012. After this, room prices will be higher.** Be sure to let the hotel know that you will be staying for the Kentucky Fruit and Vegetable Conference to obtain our special suite room rate (they are all suites) of \$115.00. If you are told that the block of rooms at our conference rate is full on or before Jan 2, please call Amy Stamper at Embassy Suites (859-455-5109) to increase the number of rooms that we have blocked. The room cost includes an evening managers' reception with drinks and a full cooked-to-order breakfast daily. We encourage growers to stay at Embassy Suites Hotel to help cover meeting overhead expenses. Note: if the hotel parking lot is full, meeting attendees may park along Aristides Street in front of the hotel.

The \$30 meeting registration fee includes a year's membership in the KVGA, KSHS or OAK and entrance into the Grape & Wine Short Course. Please see the registration form to become a member of the Kentucky Vineyard Society and to sign up for the meal functions and the Celebration of Kentucky Wines.

The enclosed pre-registration form enables you to preregister so your tickets and name tag will be ready for you when you arrive at the meeting. NOTE: WE STRONGLY URGE YOU TO PRE-REGISTER. LUNCHEON TICKETS MAY NOT BE AVAILABLE AT THE REGISTRATION DESK. NAME BADGES WILL BE REQUIRED TO ENTER MEETING ROOMS. PRE-REGISTRATION FORMS NEED TO BE IN OUR HANDS BY TUESDAY DECEMBER 20, 2011. Phone registrations will not be accepted. Participants that do not pre-register may register at the door. If you would like to serve on the KVGA or KSHS boards of directors or would like to nominate another member, please designate this on your registration sheet.

If circumstances are such that you cannot attend the meeting and would like to remain a member of the KVGA, KSHS, KVS, or OAK, please complete and return the form to Ms. Mary Ann Kelley, Research & Education Center, P.O. Box 469, Princeton, KY 42445 to continue your association membership.

Sincerely,

Robert Stone, President  
KY Vegetable Growers Association

Larry Ayres, President  
KY State Horticultural Society

**KENTUCKY STATE HORTICULTURAL  
SOCIETY OFFICERS**

President: Larry Ayres, Owenton  
Vice-President: Jeremy Hinton, Hodgenville  
Secretary: Doug Archbold, Lexington  
Treasurer: Cindy Peake, Mt. Sterling  
Directors: Donald Davis, South Shore  
Joanna Hinton, Hodgenville  
Terry Peake, Mt. Sterling  
Ray Armstrong, Shepherdsville  
Cal Blake, Lexington  
Maurice Fegenbush, Bloomfield  
Mat Gajdzik, Shelbyville  
Jonathan Price, Bowling Green  
Katie Reid, Owensboro

Advisors: Ed Fackler, New Salisbury, IN  
Kirk Pomper, Frankfort  
John Strang, Lexington  
Shawn Wright, Jackson

**KENTUCKY VEGETABLE GROWERS  
ASSOCIATION OFFICERS**

President: Robert Stone, Paris  
Vice-President: Butch Case, Cynthiana  
Secretary: Beth Wilson, Somerset  
Treasurer: Kevin Trunnell, Utica  
Directors: John Bell, Georgetown  
Brent Lackey, Somerset  
Zeldon Angel, Winchester  
Sandi Deutsch, Taylorsville  
Annette Meyer-Heisdorffer,  
Owensboro  
C.A. Pantle, Jr., Owensboro  
Linda McMaine, Salvisa  
Sarah Fannin, West Liberty  
Larry Snell, Elizabethtown  
Adam Watson, Frankfort  
Joel Wilson, Nancy

Advisors: Tim Coolong, Lexington  
Mac Stone, Frankfort  
John Strang, Lexington  
Shawn Wright, Jackson

**KENTUCKY FARMERS' MARKET  
ASSOCIATION OFFICERS**

President: Janet Eaton, Wilmore  
Vice-President: Larry Ayres, Owenton  
Secretary: Stephanie Wetzel, Richmond  
Treasurer: Janet Eaton, Wilmore  
Directors: Linda McMaine, Salvisa  
Ron Gurelle, Walton  
Sandy Corlett, Shelbyville  
Jane O'Tiernan, Richmond

**ORGANIC ASSOCIATION OF  
KENTUCKY OFFICERS**

President: Larry Brandenburg, Shelbyville  
Vice-President: Kim Jordon, Frankfort  
Secretary: Brian Geier, Frankfort  
Treasurer: Molly Stotts, Winchester  
Directors: Ben Abell, Lexington  
John Bell, Georgetown  
Cheryll Frank, Georgetown  
Sarah Fritchner, Louisville  
Deborah Hill, Frankfort

Advisors: Michael Bomford, Frankfort  
Sean Clark, Berea  
Tim Coolong, Lexington  
Michael Fitzgerald, Frankfort  
Mark Williams, Lexington

**KENTUCKY VINEYARD  
SOCIETY OFFICERS**

President: Lowell Land, Richmond  
Vice-President: Bruce Kunze, Utica  
Secretary: Chad Peach, Frankfort  
Treasurer: Alex Ackerman, Lebanon  
Executive Dir: Alicia McGuire, Lexington  
Directors: Tom Beal, Nicholasville  
Jim Hatchett, Springfield  
Bob Karsner, Willisburg  
Roger Leasor, Lexington  
Joey Sloan, Lawrenceburg  
Zane Burton, Somerset

**KENTUCKY WINE ASSOCIATION**

President: Eddie O'Daniel, Bloomfield

**All Times Are Eastern Standard Time**

**WEDNESDAY, JANUARY 4  
PRE-CONFERENCE SESSIONS**

- 3:00-5:30 p.m.      **WINEMAKING TECHNIQUES WORKSHOP**  
Coldstream 1 & 2 Rooms  
Patsy Wilson and Jeff Wheeler, Presiding
- 7:30-9:00 p.m.      **FRUIT ROUND TABLE DISCUSSION**  
Coldstream 4 Room  
John Strang, Presiding
- 5:00-9:00 p.m.      **Exhibitor Set-up**  
Pre-Function Area & Lower Atrium

**Literature Table**

**Central Kentucky Ag. Credit**  
640 South Broadway  
P.O. Box 1290  
Lexington, KY 40588  
PH: 859-253-3249  
cbrock@AgCreditOnline.com

**Nourse Farms, Inc.**  
41 River Rd.  
South Deerfield, MA 01373  
PH: (413) 665-2658  
info@noursefarms.com

**Stokes Seeds**  
13265 Howe Rd.  
Fishers, IN 46038  
PH: 317-409-3445  
kwagner@stokeseeds.com

## **THURSDAY, JANUARY 5**

8:00 a.m. Exhibits Open, Pre-Function & Lower Atrium Areas  
8:00 a.m. Registration, Pre-Function area outside meeting rooms  
Meeting registration is \$30.00. Please see the registration form for association memberships.

### **(1) KSHS-KVGA JOINT SESSION**

*Coldstream 3 Room  
Robert Stone Presiding*

8:45 a.m. Welcome - Larry Ayres  
8:55 a.m. Horticulture Department Update - Bob Houtz  
9:00 a.m. Horticulture Council Update - Jeff Hall  
9:15 a.m. Kentucky Department of Agriculture Produce Marketing Update - James Comer, Commissioner of Ag.  
9:30 a.m. The Kentucky Food Systems Innovation Center - Melissa Newman  
9:45 a.m. Introduction to Applying for Grants - Larry Snell  
10:00 a.m. The Vegetable Scene in China - John Snyder  
10:30 a.m. Cider/Coffee Break and Visit Exhibits - Pre-Function and Lower Atrium Areas  
11:00 a.m. Kentucky Grown Ag Product State Resort Park Purchasing - Gerry Van Der Meer  
11:15 a.m. Entrepreneurial Training - Kim Strohmeier  
11:30 a.m. Herbicide Residues in Hay, Mulch and Compost - J.D. Green  
11:45 a.m. Heavy Metal Soil and Water Contamination - Edwin Ritchey

### **(2) WINEMAKING**

*Coldstream 1 & 2 Rooms  
Jeff Wheeler, Presiding*

9:00 a.m. Sheet Filtration - Conor O'Hara  
9:30 a.m. Membrane Filtration - Ed Marchetti  
10:00 a.m. Winery Sanitation - Joe Lutomske  
10:30 a.m. Cider/Coffee Break and Visit Exhibits - Pre-Function and Lower Atrium Areas  
11:00 a.m. Late Harvest Wine: Cultivar Selection & Wine Tasting - Jeff Wheeler

### **(3) ORGANIC ASSOC. OF KENTUCKY WINTER MEETING**

*Fayette Room  
Larry Brandenburg, Presiding*

11:00 a.m. Organic Association of Kentucky Winter Meeting

## All Times Are Eastern Standard Time

### THURSDAY AFTERNOON, JANUARY 5

12:00 noon **EXHIBITORS AND GROWERS LUNCHEON** - Coldstream 1 & 2 Rooms

12:00 noon. **KVGA AND KSHS BOARD MEETINGS**

Board members should pick up their lunch at the Coldstream 1 & 2 buffet and then meet in the designated room at the top of the stairs located over the meeting rooms.

*Kentucky State Horticultural Society - Paris Room*

*Kentucky Vegetable Growers Association - Georgetown Room*

1:30 p.m. **KVS BOARD MEETING**

*Kentucky Vineyard Society Board Meeting - Paris Room*

*Lowell Land, Presiding*

### **5 CONCURRENT SESSIONS**

Concurrent sessions will enable participants to attend topics of interest in different sessions

#### **(4) FARMERS' MARKETS**

*Coldstream 1 & 2 Rooms*

*Sharon Spencer, Presiding*

#### **(5) AGRITOURISM AND SOCIAL MEDIA**

*Coldstream 3 Room*

*Ben Shaffar and*

*Kristin Goodin, Presiding*

#### **(6) VEGETABLE PRODUCTION**

*Coldstream 4 Room*

*Glen Roberts, Presiding*

|           |  |           |   |           |  |
|-----------|--|-----------|---|-----------|--|
| 1:30 p.m. | Home-based Processor and Micro-processor - Everything You Need to Know<br>- Shadrick Adams and Donna Stucker | 1:30 p.m. | Are You Ready for Motor Coach Tours?<br>- Pam Upton   | 1:30 p.m. | Cover Crops, Crop Rotation, Weed Control, and Nutrient Contributions<br>- Annette Wszelaki   |
| 2:00 p.m. | Heirloom Vegetables - Old is New Again<br>- Bill Best  | 2:00 p.m. | How to Effectively Garner and Conduct School Tours at Your Agritourism Business - Cindy Peake | 2:00 p.m. | Continued  |
| 2:30 p.m. | Cider/Coffee Break and Visit Exhibits<br>- Pre-Function and Lower Atrium Areas                               | 2:30 p.m. | Cider/Coffee Break and Visit Exhibits - Pre-Function and Lower Atrium Areas                   | 2:30 p.m. | Cider/Coffee Break and Visit Exhibits - Pre-Function and Lower Atrium Areas  |
| 3:10 p.m. | Farmers' Market of the Year Competition Summary - Janet Eaton  | 3:10 p.m. | Marketing your Business through Facebook and Twitter - Anna Lucio                             | 3:10 p.m. | Vegetable Cultivar Trial Results (Peas, Eggplant, Seedless Watermelon, and Heirloom Tomatoes)<br>- Tim Coolong, Chris Smigell, and Crystal Sparks, |
| 3:40 p.m. | Ag Genius Awards - Farmers' Market and Mechanization Innovations<br>- John Wilhoit                           | 3:40 p.m. | 2012 USDA Grant and Loan Programs - Jeff Jones  | 3:40 p.m. | Vegetable Crop Evapotranspiration and Irrigation in Tomatoes<br>- Nathan Howell  |
|           |  | 4:10 p.m. | What You Need to Know Before You Start Adding Value to Products<br>- Angela Anandappa         | 4:10 p.m. | Vegetable Crop Irrigation and Mulches - Tim Coolong  |
|           |  |           |   | 4:40 p.m. | Continued  |

**(7) TREE FRUIT AND BLUEBERRY  
PRODUCTION**

*Coldstream 5 Room  
Ray Tackett, Presiding*

- 1:30 p.m. Peach Irrigation and Fertigation  
- Dave Lockwood
- 2:00 p.m. Sensor Equipped Smart Sprayers - Joe Luck
- 2:30 p.m. Cider/Coffee Break and Visit Exhibits  
- Pre-Function and Lower Atrium Areas
- 3:10 p.m. Fungicide Resistance and Fungicide Rates  
- Mike Ellis
- 3:40 p.m. Acid Injection to Adjust Soil pH in Blueberries  
- Dave Lockwood
- 4:10 p.m. Apple Rootstocks - John Strang
- 4:40 p.m. MAIA Progress and New Apple Cultivar Tasting  
- Diane Miller, Ed Fackler and Jozsef Racsko

**(8) ASSOCIATION MEETINGS**

*Fayette Room*

- 1:30 p.m. Kentucky Wine Association Meeting,  
- Eddie O'Daniel, Presiding
- 2:30 p.m. Cider/Coffee Break and Visit Exhibits  
- Pre-Function and Lower Atrium Areas
- 3:10 p.m. Kentucky Grape and Wine Council  
Meeting  
- Dennis Walter, Presiding

**THURSDAY EVENING, JANUARY 5**

5:00 p.m. **Exhibits Close**

5:00-6:00 p.m. **CELEBRATION OF KENTUCKY WINES**

*Featuring Commercial Kentucky Wines - Coldstream 1 & 2 Rooms*

Sponsored by the KVS. The cost is \$15.00 for the tasting. (Baker-Bird Winery, Crocker Farm Winery, Generation Hill Winery, Glisson Vineyards & Winery, Grimes Mill Winery, McIntyre's Winery & Berries, MillaNova Winery, Misty Meadow Winery, Rock Springs Vineyard & Winery, The Little Kentucky River Winery, Verona Vineyards)

6:30-9:00 p.m. **RECEPTION AND KY FARMERS' MARKET ASSOCIATION ANNUAL MEETING**

*Coldstream 3 Room  
Janet Eaton, Presiding*

## FRIDAY MORNING, JANUARY 6

- 8:00 a.m. Exhibits Open, Pre-Function and Lower Atrium Areas  
8:00 a.m. Registration, Pre-Function Area outside meeting rooms

### 5 CONCURRENT SESSIONS

Concurrent sessions will enable participants to attend topics of interest in different sessions.

#### (9) ORGANIC FARMING AND GARDENING

*Coldstream 1 & 2 Rooms*  
*Michael Fitzgerald, Presiding*

#### (10) VEGETABLE PRODUCTION

*Coldstream 3 Room*  
*Jay Hettmansperger, Presiding*

- |            |  |            |  |
|------------|--|------------|--|
| 8:30 a.m.  | Fall Cole Crop Production<br>- Ben Abell   | 8:30 a.m.  | Plant Disease Resistance and Induced Resistance - Kenny Seebold  |
| 9:00 a.m.  | The Search for Organic Alternatives to Copper Fungicides - Paul Vincelli             | 9:00 a.m.  | Bacterial Fruit Blotch, Vegetable Fungicide, Insecticide, and Herbicide Changes<br>- Kenny Seebold, Ric Bessin, and Shawn Wright |
| 9:30 a.m.  | The NRCS EQUIP Program<br>- Kate Little  | 9:30 a.m.  | KVGA Annual Business Meeting   |
| 10:00 a.m. | Cider/Coffee Break and Visit Exhibits<br>- Pre-Function and Lower Atrium Areas       | 10:00 a.m. | Cider/Coffee Break and Visit Exhibits<br>- Pre-Function and Lower Atrium Areas   |
| 10:40 a.m. | Organic Pawpaw, Sweet Sorghum, and Primocane Blackberry Production<br>- Kirk Pomper  | 10:40 a.m. | Grower Vegetable Demonstration Plot Results<br>- Ty Cato, Vaden Fenton, and Dave Spalding  |
| 11:45 a.m. | <b>GROWER AWARDS LUNCHEON</b><br>- Coldstream 1 & 2 Rooms<br>Robert Slone, Presiding | 11:10 a.m. | Asparagus Production - Shawn Wright  |

## FRIDAY AFTERNOON, JANUARY 6

Concurrent sessions will enable participants to attend topics of interest in different sessions.

#### (14) SMALL FRUIT PRODUCTION

*Coldstream 1 & 2 Rooms*  
*Andrea Dee, Presiding*

#### (15) MARKETING

*Coldstream 3 Room*  
*Brett Reese, Presiding*

- |           |  |           |  |
|-----------|--|-----------|--|
| 1:30 p.m. | The Rotatable Cross Arm Trellis for Blackberries - Richard Barnes            | 1:30 p.m. | Economic Impacts of Sampling at Farmers' Markets - TBA                       |
| 2:00 p.m. | Continued  | 2:00 p.m. | Market Maker Training<br>- Tim Woods   |
| 2:30 p.m. | Cider/Coffee Break<br>- Pre-Function and Lower Atrium Areas                  | 2:30 p.m. | Cider/Coffee Break - Pre-Function and Lower Atrium Areas                     |
| 3:10 p.m. | Taking on The Most Prominent Strawberry and Bramble Diseases<br>- Mike Ellis | 3:10 p.m. | Restaurant Rewards and Point of Purchase Merchandising<br>- Angela Caporelli |
| 3:40 p.m. | Growing Black Raspberries<br>- Shawn Wright                                  | 3:40 p.m. | Farm-to-School Program<br>- Sarah Fritschner                                 |
| 4:10 p.m. | Table Grapes Can Be Very Profitable<br>- Sean Lynch                          | 4:10 p.m. | An Introduction to The H2A Program<br>- Rick Alexander                       |

## FRIDAY MORNING, JANUARY 6

- 8:00 a.m. Exhibits Open, Pre-Function and Lower Atrium Areas  
8:00 a.m. Registration, Pre-Function Area outside meeting rooms

### 5 CONCURRENT SESSIONS

Concurrent sessions will enable participants to attend topics of interest in different sessions.

#### (11) GRAPE & WINE

##### SHORT COURSE

*Coldstream 4 Room*  
*Lowell Land, Presiding*

- 8:55 a.m. Welcome Address  
- Lowell Land  
9:00 a.m. Effective Vineyard Spraying  
- Understanding Your Sprayer  
- Andrew Landers  
9:30 a.m. Continued  
10:00 a.m. Cider/Coffee Break and Visit  
Exhibits - Pre-Function and  
Lower Atrium Areas  
10:40 a.m. Waste Not - Want Not!  
- Methods of Improving Spray  
Deposition and Reducing Drift  
- Andrew Landers  
11:10 a.m. Continued  
11:45 a.m. GROWER AWARDS LUNCHEON

#### (12) TREE FRUIT

*Coldstream 5 Room*  
*Lowell Hamilton, Presiding*

- 8:30 a.m. Tree Fruit Spray Guide  
Update and Pest  
Management Changes  
- Ric Bessin, Nicole Ward,  
and John Strang  
9:00 a.m. Brown Rot Control in  
Stone Fruit - Nicole Ward  
9:30 a.m. Glyphosate and Winter  
Hardiness - Kyle Daniel  
10:00 a.m. Cider/Coffee Break and  
Visit Exhibits - Pre-  
Function and Lower Atrium  
10:40 a.m. Reducing Organophosphate  
Use in Apples, Grower  
Discussion - Ric Bessin  
11:10 a.m. KSHS Annual Business  
Meeting

#### (13) BLUEBERRY

##### PRODUCTION

*Fayette Room*  
*Dennis Morgeson, Presiding*

- 8:30 a.m. Basic Blueberry  
Production - Jeff Kindhart  
9:00 a.m. Netting for Bird Control  
in Blueberries  
- Nancy McCormick,  
Dana Reed, Kevan Evans  
9:30 a.m. Common Reasons for  
Failure - Jeff Kindhart  
10:00 a.m. Cider/Coffee Break and  
Visit Exhibits - Pre-Function  
and Lower Atrium Areas  
10:40 a.m. Blueberry Automated  
Simulated Pulsed Irrigation  
- John Strang  
11:10 a.m. Blueberry Disease Control  
- Mike Ellis

## FRIDAY AFTERNOON, JANUARY 6

Concurrent sessions will enable participants to attend topics of interest in different sessions.

#### (16) GRAPE AND WINE SHORT COURSE

*Coldstream 4 Room*  
*Alicia McGuire, Presiding*

- 1:30 p.m. Grape Disease Identification  
and Timing of Control  
- Mike Ellis  
2:30 p.m. Cider/Coffee Break - Pre-  
Function and Lower Atrium Areas  
3:10 p.m. Alternative Control Methods for  
Japanese Beetles - Ric Bessin  
3:40 p.m. Economic Impact Study  
- Tim Woods  
4:10 p.m. State of the Industry  
- Dennis Walter and KDA  
4:45 p.m. Ag Genius Awards Ceremony  
5:15-6:45 p.m. KVS Closing Reception and  
Ag Genius Wine Tasting  
(*Bourbon Room*) - Lowell Land  
& Alicia McGuire

#### (17) Hydroponic Tomato Production

*Coldstream 5 Room*  
*Kelly Jackson, Presiding*

- 1:30 p.m. Water Quality  
- Steve Berberich  
2:00 p.m. Hydroponic Tomato  
Production  
- Rick Snyder  
2:30 p.m. Cider/Coffee Break  
- Pre-Function and Lower  
Atrium Areas  
3:10 p.m. Continued  
- Rick Snyder  
3:40 p.m. Continued  
4:10 p.m. Continued

#### (18) WHOLESALE MARKETING

*Fayette Room*  
*Adam Watson, Presiding*

- 1:30 p.m. GAP Update and Develop  
ments /Q&A Third Party  
Audits Grower Panel  
2:00 p.m. Out-of-Season  
Production for Farm-to-  
School Markets  
- Tim Coolong  
2:30 p.m. Cider/Coffee Break  
- Pre-Function and Lower  
Atrium Areas  
3:10 p.m. One-On-One Meeting with  
Wholesalers  
3:40 p.m. Continued  
4:10 p.m. Continued

## WHO'S WHO 2012

**Ben Abell**, UK Horticulturist,  
Lexington, KY

**Shadrick Adams**, Food Manufacturing  
Supervisor, Food Safety Branch, Dept.  
of Public Health, Frankfort, KY

**Rick Alexander**, Agriculture Workforce  
Management Assoc., Lexington, KY

**Angela Anandappa**, FSIC Program  
Coordinator, UK Food Systems  
Innovation Center, Lexington, KY

**Larry Ayres**, President, Kentucky State  
Horticultural Society, Grower, Owenton,  
KY

**Richard Barnes**, Trellis Growing  
Systems, LLC, Fort Wayne, IN

**Steve Berberich**, UK Extension Associ-  
ate for Floral Crops, Lexington, KY

**Dr. Ric Bessin**, UK Extension  
Entomologist, Lexington, KY

**Bill Best**, Grower, Sustainable Mountain  
Agricultural Center, Berea, KY

**Dinah Bird**, Baker-Bird Winery,  
Augusta, KY

**Susan & John Bond**, Rock Springs  
Vineyard & Winery, Grayson, KY

**Larry Brandenburg**, President, Organic  
Assoc. of Kentucky, Grower, Harmony  
Fields Farm, Shelbyville, KY

**Bill & Sherry Buda**, Generation Hill  
Winery, Alexandria, KY

**Angela Caporelli**, Aquaculture Coord-  
inator, Kentucky Dept. of Agriculture,  
Frankfort, KY

**Ty Cato**, Shelby County Vegetable  
Extension Associate, Univ. of Kentucky,  
Shelbyville, KY

**James Comer**, KY  
Commissioner of Agriculture  
Frankfort KY

**Dr. Tim Coolong**, UK Extension Veg-  
etable Specialist, Lexington, KY

**Dan Crocker**, Crocker Farm Winery,  
Franklin, KY

**Kyle Daniel**, The Ohio State Univ.,  
Columbus, OH

**Andrea Dee**, Kenton County UK  
Extension Agent for Horticulture,  
Covington, KY

**Phil Desimone**, Grimes Mill Winery,  
Lexington, KY

**Janet Eaton**, Grower, President  
KFMA, Wilmore, KY

**Dr. Mike Ellis**, Extension Plant Pa-  
thologist, OARDC - Plant Pathology,  
The Ohio State Univ., Wooster, OH

**Kevan Evans**, Grower, Evans Orchard  
and Cider Mill, Georgetown, KY

**Ed Fackler**, Grower, New Salisbury,  
IN

**Vaden Fenton**, Vegetable and Small  
Fruit Extension Associate, UKREC,  
Princeton, KY

**Michael Fitzgerald**, Organic Program  
Coordinator, Division of Value Added  
Plant Production, Kentucky Dept. of  
Agriculture, Frankfort, KY

**Sarah Fritschner**, Betterworld-PR,  
Louisville, KY

**Steve Glisson**, Glisson Vineyards &  
Winery, Paducah, KY

**Kristin Goodin**, Barren County UK  
Horticulture Extension Agent, Glas-  
gow, KY

**Dr. J. D. Green**, UK Extension Weed  
Specialist, Lexington, KY

**Jeff Hall**, Executive Director,  
Kentucky Horticultural Council,  
Louisville, KY

**Lowell Hamilton**, Breathitt County  
UK Extension Agriculture and Natural  
Resources Agent, Jackson, KY

**Jay Hettmansperger**, Garrard County  
UK Extension Agricu-  
ture and Natural Resources Agent, Lan-  
caster, KY

**Dr. Bob Houtz**, Chair, UK Horticulture  
Dept., Lexington, KY

**Nathan Howell**, Viticultural Techni-  
cian, Western Kentucky Univ., Bowling  
Green, KY

**Kelly Jackson**, Christian County  
UK Extension Agent for Horticulture,  
Hopkinsville, KY

**Jeff Jones**, Rural Development,  
Lexington, KY

**Donald Keller**, Misty Meadow  
Winery, Owensboro, KY

**Jeff Kindhart**, Senior Research Spe-  
cialist, Dixon Springs Agricultural  
Center, Simpson, IL

**Lowell Land**, President, Kentucky  
Vineyard Society, Acres of Land  
Winery, Richmond, KY

**Dr. Andrew Landers**, Cornell  
Univ., Barton Laboratory, New York  
Agricultural Experiment Station,  
Geneva, NY

**Kate Little**, Resource Conservationist,  
NRCS, Lexington, KY

**Dr. Dave Lockwood**, Extension Fruit  
Specialist, Plant Sciences, Univ. of Ten-  
nessee, Knoxville, TN

**Anna Lucio**, Marketing Specialist,  
Division of Value Added Plant  
Production, Kentucky Dept. of Agric.,  
Frankfort, KY

**Joe Luck**, UK Engineer Associate,  
Lexington, KY

**Sean Lynch**, UK Farm Technician,  
Lexington, KY

## WHO'S WHO

**Joe Lutomske, New World Winery, Equipment,** Springfield, MO

**Ed Marchetti** - AFTEK, Inc.,  
Rochester, NY

**Nancy McCormick,** Grower, Blueberries of Daviess County, Utica, KY

**Alicia McGuire,** Executive Director, Kentucky Vineyard Society, Lexington, KY

**Tommy McIntyre,** McIntyre's Winery & Berries, Bardstown, KY

**Dr. Diane Doud Miller,** Associate Professor, Dept. of Hort. and Crop Science (OARDC), Wooster, OH

**Jim Miller,** MillaNova Winery, Mt. Washington, KY

John & Peggy Montgomery, Verona Vineyards, Verona, KY

**Dennis Morgeson,** Washington County UK Extension Horticulture Agent, Springfield, KY

**Dr. Melissa Newman,** UK Associate Professor, Lexington, KY

**Eddie O'Daniel,** President, Kentucky Wine Assoc., Springhill Winery & Plantation B 'n B, Bloomfield, KY

**Conor O'Hara,** 3M Purification Inc., Meriden, CT

**Cindy Peake,** Grower, Bramble Ridge Orchard, Mt. Sterling, KY

**Dr. Kirk Pomper,** Principal Investigator of Horticulture, Curator, USDA-National Clonal Germplasm Repository for Pawpaw, Kentucky State University, Frankfort, KY

**Dr. Jozsef Racsko,** Program Coordinator, Horticulture & Crop Science, OARDC, Wooster, OH

**Dana Reed,** Grower, Reed Valley Orchard, Paris, KY

**Brett Reese,** Shelby County UK Extension Agriculture and Natural Resources Agent, Shelbyville, KY

**Dr. Edwin Ritchey,** Extension Soil Specialist, UKREC, Princeton, KY

**Glen Roberts,** Wayne County UK Extension Agriculture and Natural Resources Agent, Monticello, KY

**Dr. Kenny Seebold,** UK Extension Plant Pathologist, Lexington, KY

**Ben Shaffar,** Kentucky Dept. of Agriculture, Frankfort, KY

**Larry Snell,** Executive Director, Kentucky Center for Cooperative Development, Elizabethtown, KY

**Chris Smigell,** UK Small Fruit and Vegetable Extension Associate, Lexington, KY

**Dr. John Snyder,** Teaching and Research, UK Horticulture Dept., Lexington, KY

**Dr. Rick Snyder,** Extension Specialist for Greenhouse and Field Vegetable Crops, Mississippi State Univ., Truck Crops Branch Experiment Station, Crystal Springs, MS

**Dave Spalding,** UK Vegetable Extension Associate, Lexington, KY

**Crystal Sparks,** UK Horticultural Technician, Robinson Station, Jackson, KY

**Sharon Spencer,** Farmers' Market Marketing Specialist, Kentucky Dept. of Agriculture, Frankfort, KY

**Robert Stone,** President Kentucky Vegetable Growers Assoc., Paris, KY

**Dr. John Strang,** UK Extension Fruit and Vegetable Specialist, Lexington, KY

**Kim Strohmeier,** Owen County UK Agriculture and Natural Resources Agent, Owenton, KY

**Donna Stucker,** Environmental Health Inspector Program Evaluator, Food Safety Branch, Dept of Public Health, Frankfort, KY

**Ray Tackett,** Bourbon County UK Extension Horticulture Agent, Paris, KY

**Pam Upton,** Blue Grass Tours, Lexington, KY

**Gerry Van Der Meer,** Commissioner of Kentucky State Parks, Frankfort, KY

**Dr. Paul Vincelli,** UK Extension Plant Pathologist, Lexington, KY

**Dennis Walter,** Chair, Kentucky Grape & Wine Council, StoneBrook Winery, Camp Springs, KY

**Dr. Nicole Ward,** UK Extension Plant Pathologist, Lexington, KY

**Adam Watson,** Fruit and Vegetable Marketing Specialist, Div. of Value Added Plant Production, KY Dept. of Agriculture, Frankfort, KY

**Teresa & David Weyler,** The Little Kentucky River Winery, Bedford, KY

**Jeff Wheeler,** UK Research Analyst, Lexington, KY

**Dr. John Wilhoit,** UK Extension Specialty Crop Mechanization Specialist, Lexington, KY

**Patsy Wilson,** UK Extension Viticulturist, Lexington, KY

**Dr. Tim Woods,** UK Agricultural Economics Extension Specialist, Lexington, KY

**Dr. Shawn Wright,** UK Extension Horticulture Specialist, Robinson Center for Appalachian Resource Sustainability, Jackson, KY

**Dr. Annette Wszelaki,** Commercial Vegetable Production Specialist, Plant Sciences Dept., Univ. of Tennessee, Knoxville, TN

# Exhibitors 2012

**All American Containers**  
216 Finley Rd.  
Belle Vernon, PA 15012  
phone: 315-585-6045  
*rparmelee@allamerican  
containers.com*

**Arton Products**  
PO Box 340  
Lively, VA 22507  
Phone: (804) 462-5800 ext. 115  
*roberts@artonproducts.com*

**Brandt Consolidated Inc.**  
2935 So. Koke Mill Rd.  
Springfield, IL 62711  
Phone: 217-891-3651  
*brad.engel@brandt.co*

**Brick Packaging**  
1677 Park Drive  
Traverse City, MI 49686  
phone: 231-947-4950  
*danbrick@brickpackaging.com*

**Bunton Seed Company**  
939 E. Jefferson St.  
Louisville, KY 40206  
phone: 502-584-0136  
*pam@buntonseed.com*

**Charles Compost**  
1195 Hwy 815  
Calhoun, KY 42327  
phone: 270-499-1435  
*charlescompost@gmail.com*

**Clifton Seed Company**  
P.O. Box 206  
Faison, NC 28341  
phone: 910-260-0252  
*edr@cliftonseed.com*

**Continental Industries**  
P.O. Box 865  
Shepherdsville, KY 40165  
phone: 502-543-2600  
*jchamilton@windstream.net*

**Criveller Company**  
6935 Oakwood Dr.  
Niagara Falls, ON L2E655  
phone: 905-357-2930  
*dmacoreta@criveller.com*

**Crops Diversification & Biofuel Res. & Ed. Ctr.**  
N-318 Ag. Science Bldg. North  
University of KY  
Lexington, KY 40546  
phone: 859-257-1477  
*cgcass0@uky.edu*

**Deerfield Supplies**  
2825 Stringtown Rd.  
Elkton, KY 42220  
phone: 270-265-2425

**Dillman Farm, Inc.**  
4955 West State Road 45  
Bloomington, IN 47403  
phone: 812-825-5525  
*carydillman@dillmanfarm.com*

**Double A Vineyards, Inc.**  
10277 Christy Rd.  
Fredonia, NY 14063  
phone: 716-672-8493  
*sue.rak@doublevineyards.com*

**Fresh Start Growers Supply**  
1007 East Jefferson Street  
Louisville, KY 40206  
phone: 502-442-7883  
*steve@freshstartgrowers.com*

**Governor's Office of Ag. Policy**  
404 Ann Street  
Frankfort, KY 40601  
phone: 502-564-4627  
*sandra.gardner@ky.gov*

**H & H Farm Machine Co., Inc.**  
7916 Unionville-Brief Rd.  
Monroe, NC 28110  
phone: 704-753-4919  
*hhspray@vnet.net*

**Hillside Orchard Farms**  
105 Mitcham Circle  
Tiger, GA 30576  
phone: 706-752-4995  
*lynn@hillsideorchard.com*

**Indiana Berry & Plant Co.**  
5218 W. 500 S  
Huntingburg, IN 47542  
phone: 812-683-3055  
*inberry@psci.net*

**Innovative Labeling Solutions**  
4000 Hamilton Middletown Rd.  
Hamilton, OH 45011  
phone: 513-526-6655  
*ottoknop@ilslables.com*

**Jackto/Richey Equipment**  
3213 Honeysuckle  
White Pine, TN 37890  
phone: 865-674-6042  
*sales@richeyequipment.com*

**KY Department of Agriculture**  
100 Fair Oaks Lane, 5th Floor  
Frankfort, KY 40601  
phone: 502-564-4983  
*stacia.alford@ky.gov*

**Kentucky Farm Bureau**  
Roadside Farm Market Program  
9201 Bunsen Parkway  
Louisville, KY 40220  
phone: 502-495-5106  
*kara.keeton@kyfb.com*

**Kentucky Irrigation Co.**  
340 Midland Place  
Lexington, KY 40505  
phone: 859-254-7022  
*bob@kentuckyirrigation.com*

**Kentucky State University  
Fruit and Vegetable Mobile  
Processing Initiative**  
129 Atwood Research Facility  
Frankfort, KY 40601  
phone: 502-597-5942

**Lincoln Co. Produce Auction**  
450 Al Wyler Rd.  
Crab Orchard, KY 40419  
phone: 606-355-0020

**Midwest Vineyard Supply**  
2300 South Twin Bridge Road  
Decatur, IL 62521  
phone: 217-864-9896  
*sales@midwestvineyardsupply.com*

**Miller Chemical & Fertilizer  
Corp.**  
P.O. Box 333  
Hanover, PA 17331  
phone: 618-525-1818  
*rabbit\_grape@yahoo.com*

**Premium Hort Supply Co.**  
915 E. Jefferson St.  
Louisville, KY 40206  
phone: 502-582-3897  
*premort@bellsouth.net*

**Rockford Package Supply**  
10421 Northland Dr.  
Rockford, MI 49341  
phone: 800-444-7225  
*hpaulson@rockfordpack.com*

**Rupp Seeds Inc.**  
17919 County Road B  
Wauseon, OH 43567  
phone: 1-800-700-1199  
*philk@ruppseeds.com*

**Scott Laboratories**  
P.O. Box 4559  
Petaluma, CA 94955  
phone: 707-765-6666  
*zacks@scottlab.com*

**Seedway, LLC**  
7520 Ruggles Ferry Pike  
Knoxville, TN 37924  
phone: 865-548-7333  
*kbhosey@gmail.com*

**Smith's Promotional Products**  
1474 Nivevah Rd.  
Frankfort, KY 40601  
phone: 502-227-7829  
*dtsmith59@aol.com*

**Southern FS**  
200 Jamestown Rd.  
Cobden, IL 62920  
phone: 618-893-4852  
*SouthernFS@cobden@  
charter.com*

**Spec Trellising Co.**  
39 Indian Drive, P.O. Box 2204  
Ivyland, PA 18974  
phone: 1-800-237-4594  
*info@spectrellising.com*

**Town & Country Specialty  
Foods, Inc.**  
P.O. Box 847  
Bardstown, KY 40004  
phone: 502-507-2974  
*foods@bardstowncable.net*

**Trellis Growing Systems, LLC**  
2427 S. Hadley Rd.  
Ft. Wayne, IN 46804  
phone: 260-241-3128  
*rcbarnes@trellisgrowingsystems.  
com*

**Wabash Valley Progressive  
Viticulture**  
8902 S. 625 W  
Rosedale, IN 47874  
phone: 765-548-0676  
*jbditzler@gmail.com*

**Waters Agricultural  
Laboratories, Inc.**  
2101 Calhoun Rd., Hwy 81  
Owensboro, KY 42301  
phone: 270-685-4039  
*jeff@watersag.com*

2nd Floor

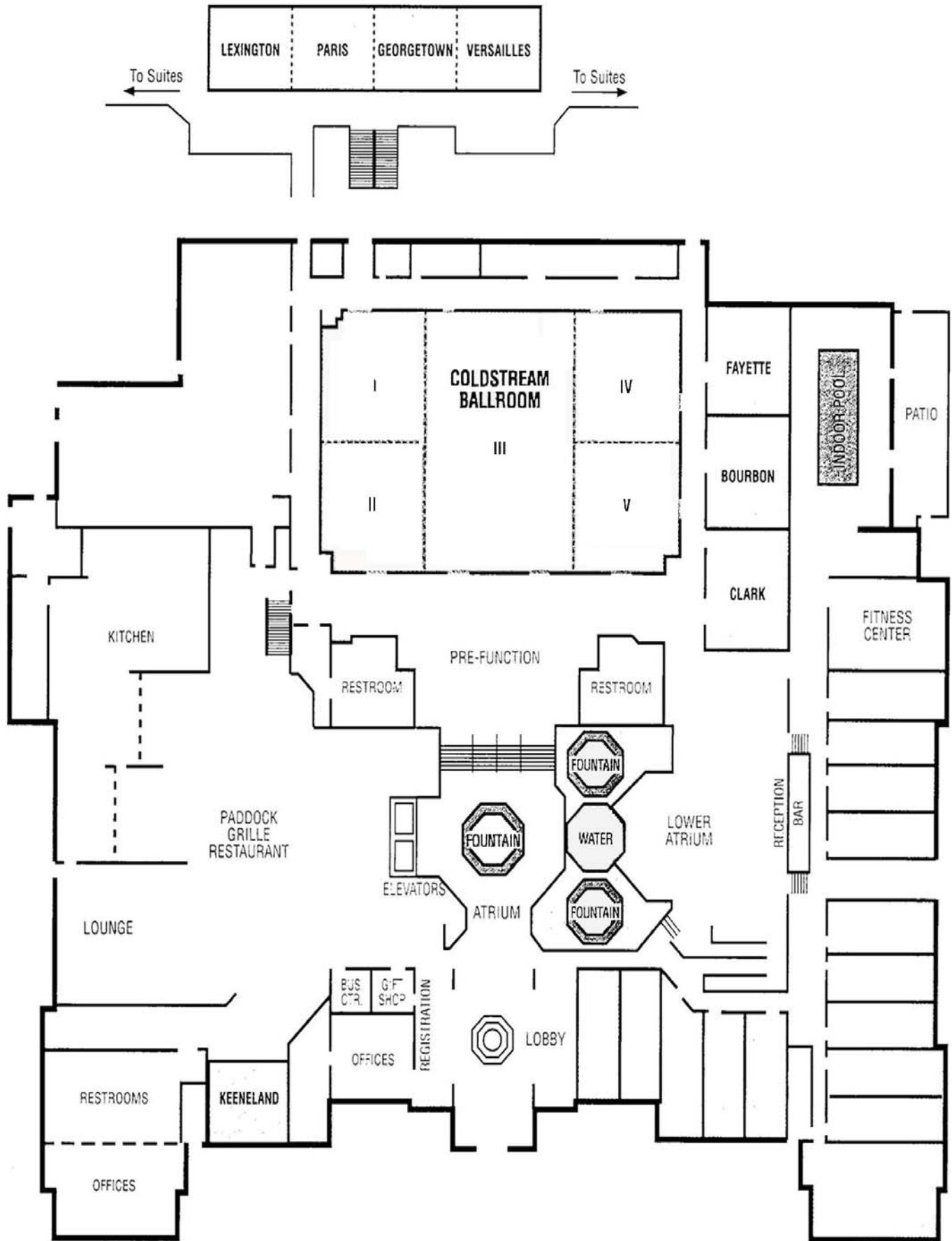

**Kentucky State Horticultural Society**

**UK Research & Education Center**

P.O> Box 469

Princeton KY 42445-0469

**DIRECTIONS**

From I-75/64: Take Exit 115 then right on to Newtown Pike. Turn right onto Aristides Blvd. at the UK Coldstream Research Campus. Hotel is on the right.

From Blue Grass Airport: Exit left on to Man O'War Blvd. to Versailles Rd. Turn right onto Versailles Rd. Take Rt. 4 New Circle Rd. north to Newtown Pike Exit North. Turn left onto Aristides Blvd. at the UK Coldstream Research Campus. Hotel is on the right.

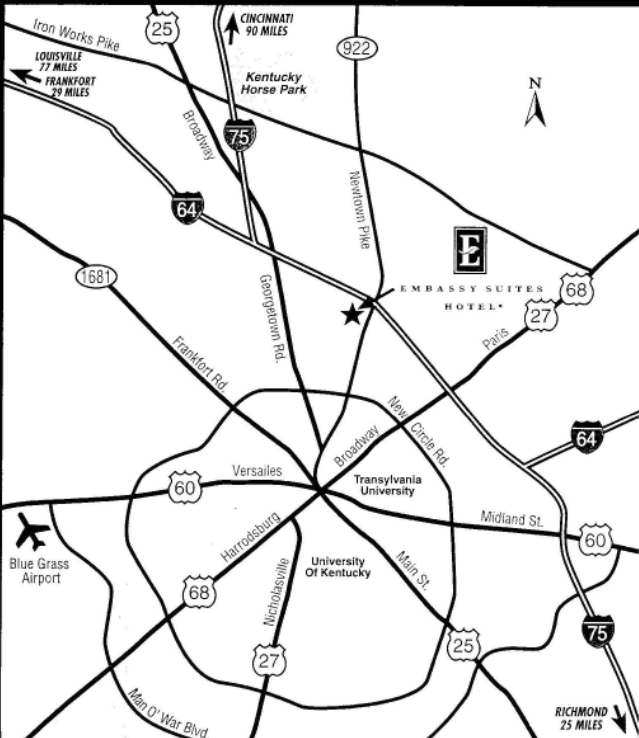

**KENTUCKY FRUIT AND VEGETABLE CONFERENCE**  
**Embassy Suites Hotel, Lexington KY -- January 5-6, 2012**

Mark one: \_\_\_\_\_ ADVANCE REGISTRATION \_\_\_\_\_ I am not able to attend--continue my membership(s) as listed below.

NAME(S) for name tag (Please print) \_\_\_\_\_

ADDRESS \_\_\_\_\_

CITY, STATE \_\_\_\_\_ ZIP \_\_\_\_\_

PHONE: ( \_\_\_\_\_ ) \_\_\_\_\_ OCCUPATION/FIRM \_\_\_\_\_

FAX: ( \_\_\_\_\_ ) \_\_\_\_\_ E-Mail \_\_\_\_\_

PLEASE LIST NAME(S) OF ADDITIONAL REGISTRANTS: \_\_\_\_\_

I recommend \_\_\_\_\_ for the  KSHS or  KVGA Board of Directors.

Complimentary registration for County Extension Agents, University Students, and children under 15 years of age accompanying an adult.

**\*\* A \$30 registration allows entrance into any conference meeting session.**

One year membership plus meeting registration.

**\$30 PER PERSON**

Kentucky State Horticultural Society ----- Number attending \_\_\_\_\_

Kentucky Vegetable Growers Association ----- Number attending \_\_\_\_\_

Organic Association of Kentucky ----- Number attending \_\_\_\_\_

Grape & Wine Short Course, Jan. 6 ----- Number attending \_\_\_\_\_

[Meeting registration only -- does not include organization membership.]

\$30 each x Total number attending \_\_\_\_\_ = TOTAL \$ \_\_\_\_\_

KVS Membership Renewal and New Member Fee -- \$25 x Number attending \_\_\_\_\_ = TOTAL \_\_\_\_\_

Register for the **Celebration of Kentucky Wines**, Jan. 5, 2012 / 5:00-6:30 PM

Number attending \_\_\_\_\_ x \$15 each = TOTAL \$ \_\_\_\_\_

**\*\*Meal tickets are available only through advance registration.**

**EXHIBITOR/GROWER LUNCHEON -- January 5, 2012 / 12:00 Noon EST**

MENU: *All American Deli Buffet -- roast beef, smoked turkey, ham, cheeses, cole slaw, mustard potato salad, chefs dessert selection*

Number attending \_\_\_\_\_ x \$26 each = TOTAL \$ \_\_\_\_\_

**AWARDS LUNCHEON - January 6, 2012 / 11:45 p.m. EST**

MENU: *KY Original Buffet -- roasted corn chowder, market salad topped with toasted pecans, roast pork with bourbon glaze, buttermilk fried chicken, bourbon whipped sweet potatoes, country green beans, warm corn break, KY Derby Pie, KY bread pudding and fruit pies*

Number attending \_\_\_\_\_ x \$33 each = TOTAL \$ \_\_\_\_\_

→ **Please make CHECKS payable to: KENTUCKY FRUIT AND VEGETABLE CONFERENCE**

CHECK # \_\_\_\_\_ CHECK AMT \$ \_\_\_\_\_ CASH AMT \$ \_\_\_\_\_ TOTAL PAID \$ \_\_\_\_\_

Mail advance registration to:

Mary Ann Kelley, Research & Education Center,  
PO Box 469, Princeton, KY 42445-0469  
Phone: 270-365-7541 x 216; Fax: 270-365-2667



Dr. John Strang, Coordinator

**ADVANCE REGISTRATION MUST BE RECEIVED BY MONDAY, DECEMBER 20, 2011**